

**Low Cost Rectangular Ceramic
Pressure Sensors for Pressure Switch
水泵控制器用低成本方形陶瓷压力传感器**

Media compatibility 介质兼容: Sensor in Alumina 96% 传感器材料为 96% 氧化铝

Measurement type 测量形式: Gauge 表压

▣ **Sensor Specification 传感器规格参数**

SENSORS P/N 料号		MSQ-10-0	MSQ-16-0
Rated Pressure Range 压力量程	bar	10	16
Overload Pressure 安全过载	bar	32	32
Burst Pressure 破坏压力	bar	40	40
Ceramic body thickness (t) 厚度	mm	1.46 +/-0.1	1.46 +/-0.1

▣ **Sensor Overall Dimensions & Picture 传感器总体尺寸及图片**

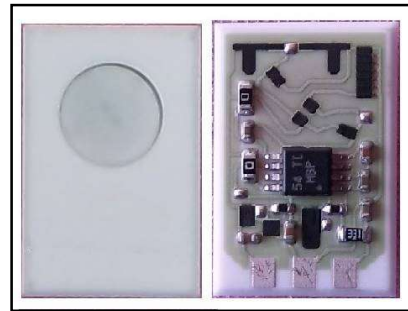
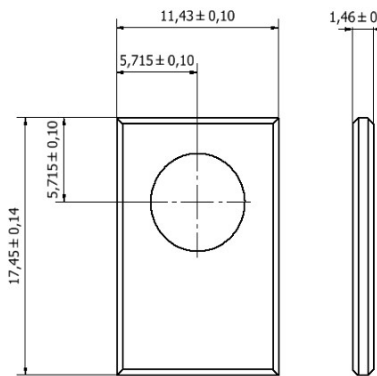

1 / 2 / 3

▣ **Environmental specification 环境参数**

Working temperature range 工作温度: -20...+85°C

▣ **Electrical specification 电气参数**

Power supply 供电电压

Output 输出

Vout of the free cell at ambient pressure 零点输出

Vout at FS (10 bar) 满量程输出

Dynamic response 动态响应

Accuracy (lin+hyst+repeatab error) 精度

Offset thermal drift (5...45°C) 零点温漂

Sensitivity thermal drift 灵敏度温漂

Output load resistance 输出负载

Current consumption 功耗

▣ **Wiring information 接线信息**

1 = + Vsupply

2 = 0V / GND

3 = + Vout

5VDC ±5%

ratiometric 比例输出

0.5±0.10 Volts

2.5±0.75 Volts

< 1ms

< 0.5% of span

< 0.1% FS/°C

<0.025%/°C

> 10kOhm

<10mA

▣ **Electrical connection 电气连接:** Customized version upon request 可根据客户要求定制

3 Tinned Pads. 3 个上锡焊盘。

Specification subject to change without prior notice. 规格参数变更无须预先通知

Sep. 2020 Issue